

## VTC 630 - 800

The vertical scraper centrifuges of the type VTC work discontinuously, the solids are discharged vertically through the top.

The application range includes pilot plants as well as small production quantities in the fine chemicals and the pharmaceutical industry.

In addition to the basic equipment, different optional equipment can be provided.

### Design features

- Simple operation and handling
- Lifting device for solid discharge through the top
- Robust design according to the latest GMP guidelines
- Optimally designed functional devices for efficient and reliable process cycles with low vibrations
- Oil free: pneumatically actuated cover
- Motor lay-out above or below base plate
- Optional clean room design using membrane connection
- CIP system, process area optionally floodable
- Easy maintenance thanks to modular design
- Compact dimensions
- Suitable for Zone 1 (according to RL 94/9/EG)



VTC	630	800	
Basket diameter	630	800	[mm]
Basket opening	440	560	[mm]
Basket height	320	400	[mm]
Filter surface	0.63	1.01	[m <sup>2</sup> ]
Useful volume (100%)	51	102	[dm <sup>3</sup> ]
Max. load (100%, $\rho$ 1'250 kg/m <sup>3</sup> )	64	128	[kg]
Max. rotor speed	1'900	1'500	[min <sup>-1</sup> ]
Max. G force	1'271	1'006	[g]
Centrifuge weight (without load)	650	1200	[kg]
Motor power for main drive <sup>1</sup>	7.5	11	[kW]

### Basic equipment

Vibration dampers. Bearing (temperature monitored). Drive with frequency controlled three-phase asynchronous motor. Welded housing (with integrated base plate). Welded cover, pneumatically operated. Basket. Feed pipe. Wash pipe.

### Optional equipment

Bearing control (vibrations). Basket with removable basket ring and lift-out filter bag. Fill level control. Filtrate outlet with compensator and/or sight glass. CIP. Inertisation system InertoSafe© (Basic, ATEX or SIL 2). Oxygen analysers. Pressure relief valve and siphon. Manually or pneumatically actuated valves. Lifting device (basket).

### Automation

See separate data sheets

<sup>1</sup> Other drive power upon request / as required

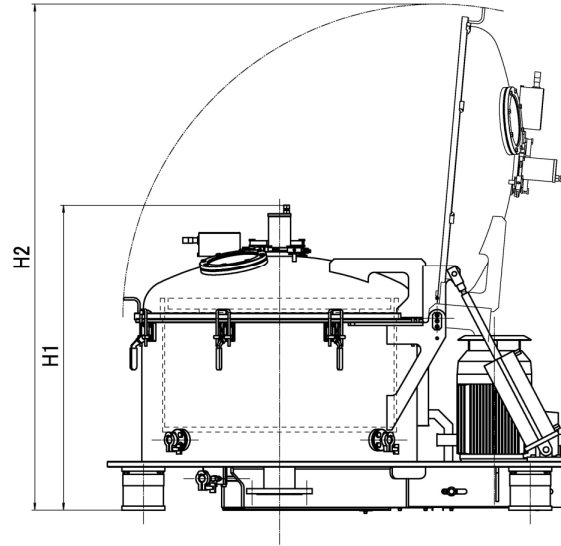
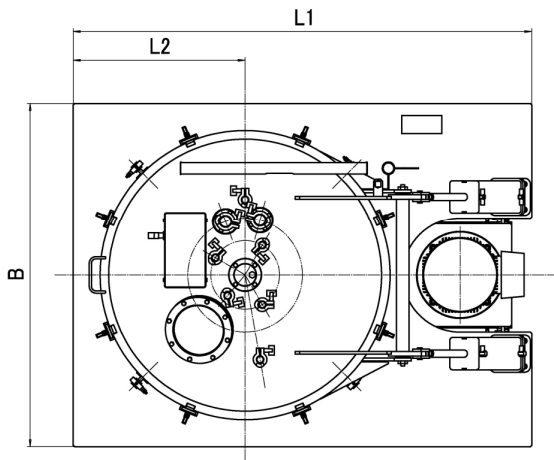

VTC	630	800	
L1	1'300	1'600	[mm]
L2	500	600	[mm]
B	1'000	1'200	[mm]
H1	915	1'070	[mm]
H2	1'445	1'770	[mm]
Design pressure	300 <sup>2</sup>		[mbarg]
Operating pressure	4 – 20		[mbarg]
Gas tightness	40 mbarg according to DIN 24400		[mbarg]
Product temperature range	0 - 80		[°C]
Max. allowable bearing temperature	95		[°C]
Ambient temperature	0 - 40 <sup>3</sup>		[°C]

<sup>2</sup> Other pressure ranges upon request  
<sup>3</sup> Other temperature ranges upon request