

VBC 630 - 800

The vertical scraper centrifuges of the type VBC work discontinuously, the solids are discharged vertically downwards.

The wide application range includes demanding continuous operation in the chemical industry as well as for complex pharmaceutical applications.

Due to high modularity and considerable upgrade possibilities our newest VBC centrifuges can meet customer requirements optimally.

Design features

- Robust design according to the latest GMP guidelines
New GMP conform bearing housing which eliminates all inaccessible areas between bearing housing and basket hub. Ferrum Patent.
- Oil free: pneumatically actuated scraper knife and cover
- Scraper knife over the entire height of the basket
- Optimally designed functional devices for efficient and reliable process cycles with low vibrations
- Motor lay-out above or below base plate
- Optional clean room design using membrane connection
- Effective residual heel removal
- CIP system, process area optionally floodable
- Easy maintenance thanks to modular design
- Compact dimensions
- Suitable for Zone 1 (according to RL 94/9/EG)



Design with motor below base plate

VBC	630	800	
Basket diameter	630	800	[mm]
Basket opening	440	560	[mm]
Basket height	320	400	[mm]
Filter surface	0.63	1.01	[m ²]
Useful volume (100%)	51	102	[dm ³]
Max. load (100%, ρ 1'250 kg/m ³)	64	128	[kg]
Max. rotor speed	1'900	1'500	[min ⁻¹]
Max. G force	1'271	1'006	[g]
Centrifuge weight (without load)	750	1'300	[kg]
Motor power for main drive	7.5	11	[kW]

Basic equipment

Vibration dampers. Bearing (temperature monitored). Drive with frequency controlled three-phase asynchronous motor. Welded housing (with integrated base plate). Welded cover, pneumatically actuated. Basket. Scraper unit, pneumatically actuated. Feed pipe. Wash pipe.

Optional equipment

Bearing control (vibrations). Fill level control. Discharge cone. Filtrate outlet with compensator and/or sight glass. CIP. Inertisation system InertoSafe[®] (Basic, ATEX or SIL 2). Oxygen analysers. Pressure relief valve and siphon. Manually or pneumatically actuated valves. Lifting device (basket).

Automation

See separate data sheets.

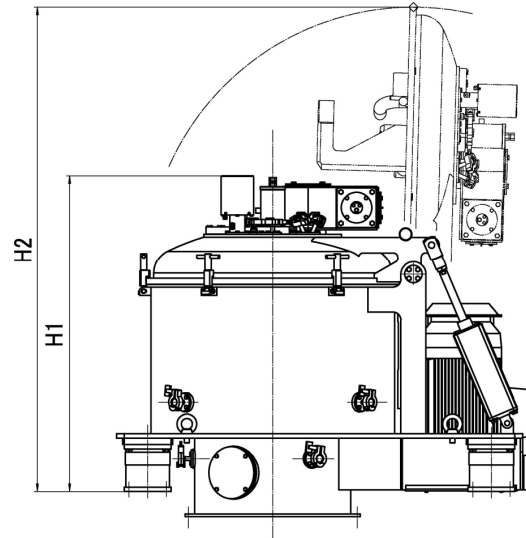
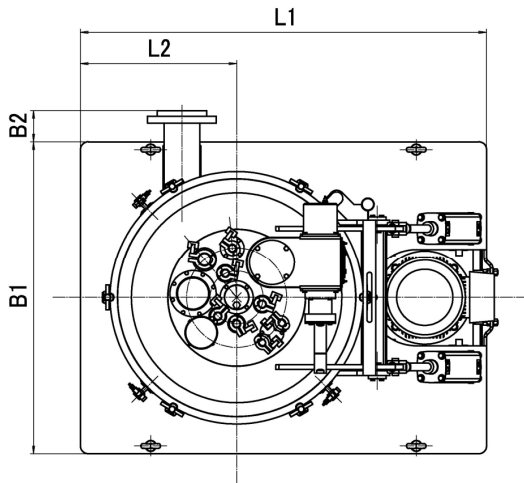

VBC	630	800	
L1	1'300	1'600	[mm]
L2	500	600	[mm]
B1	1'000	1'200	[mm]
B2	100	100	
H1	1'015	1'165	[mm]
H2	1'550	1'870	[mm]
Design pressure	300 ¹		[mbarg]
Operating pressure	4 – 20		[mbarg]
Gas tightness	40 mbarg according to DIN 24400		[mbarg]
Product temperature range	0 - 80		[°C]
Max. allowable bearing temperature	95		[°C]
Ambient temperature	0 - 40 ²		[°C]

¹ Other pressure ranges upon request
² Other temperature ranges upon request